

# WaterTech



COMPANY  
MANAGEMENT SYSTEM  
CERTIFIED BY DNV GL  
= ISO 9001 =  
= ISO 14001 =



## MID MI-001

Single-jet water meter  
with dry dial counter

ALLEFA SDC

# ALFA SDC

## Single-jet water meter with dry dial counter

### PERFORMANCE ACCORDING TO MID 2004/22/CE DIRECTIVE

SIZE		PERMANENT FLOW $Q_3$ (m <sup>3</sup> /h)	MAXIMUM FLOW $Q_4$ (m <sup>3</sup> /h)	TRANSITIONAL FLOW $Q_2$ (l/h)	MINIMUM FLOW $Q_1$ (l/h)	WORKING PRESSURE (bar)	MINIMUM READING (l)	MAXIMUM READING (m <sup>3</sup> )	TEMPERATURE CLASS
(mm)	(inch)								
13/15	1/2"	2,5	3,125	50	31,3	16	0,05	99.999	T30/T50
20	3/4"	4,0	5,000	80	50,0	16	0,05	99.999	T30/T50
25	1"	6,3	7,875	126	78,8	16	0,05	99.999	T30/T50
30	1 1/4"	10,0	12,500	200	125,0	16	0,05	99.999	T30/T50
40	1 1/2"	16,0	20,000	320	200,0	16	0,05	99.999	T30/T50

Metrological class MID ( $Q_3/Q_1$ ) R = 80

#### TYPICAL ERROR CURVE

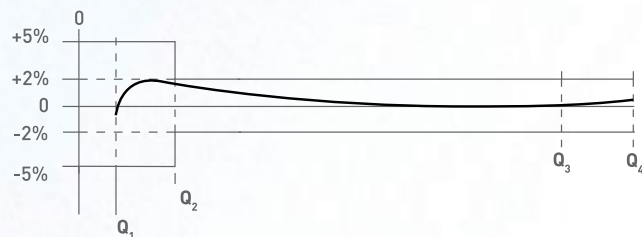

#### PRESSURE LOSS DIAGRAM

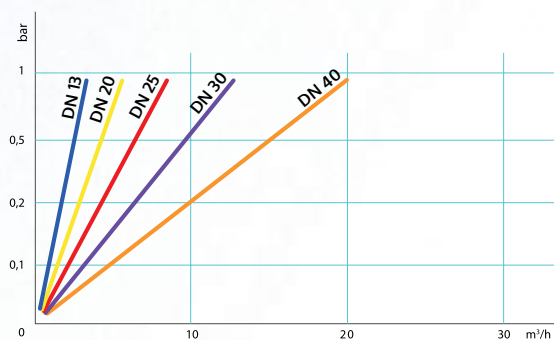

#### DIMENSIONS

(mm) SIZE (inch)	13/15	20	25	30	40
L (mm)	80 - 110 115 - 120	115 - 130	160	160	200
H (mm)	85	85	106	106	123
TOTAL LENGTH OF CONNECTORS (mm)	80	100	100	120	140

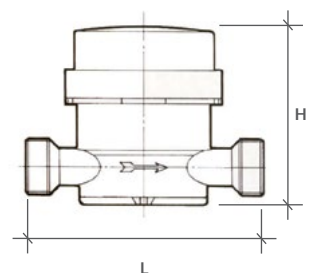

Rev. 3/2015 The content of this data sheet is intended to give general information only, we reserve the right to make alterations without prior notification

For additional information and options, do not hesitate to contact us

**WATERTECH S.P.A. - Water meters**

Factory, commercial main office and administration: Str. Antica Fornace, 2/4 • 14053 Canelli (AT) – Italy  
**Tel** +39 0141 822106-832151 • **Fax** +39 0141 832191-832198 • **Mail** info@wtmeters.it • **Web** www.wtmeters.it